

# Weddings & Venue Hire

---

[www.hallplace.org.uk](http://www.hallplace.org.uk)  
[hallplacefunctions@bexley.gov.uk](mailto:hallplacefunctions@bexley.gov.uk)  
020 3045 4088



## Welcome to Hall Place

Hall Place and Gardens is one of the most sought-after venues for weddings and ceremonies in the South East with over 400 years of history. Whether you are looking for a stunning venue for your wedding ceremony, a place to host your entire day's celebration, or looking for the perfect place for a family gathering or conference, our dedicated team can help you plan every single detail making it a truly memorable day.

We offer a range of packages and special touches for your celebration and the flexibility to use the beautiful historic spaces in any way you choose. For our wedding couples, we offer complete exclusivity.

This brochure gives an overview of the spaces available and the different ways they can be used so you can begin to imagine how Hall Place and Gardens could be the perfect venue for your next event.



## Great Hall

The Great Hall is the heart of Hall Place and Gardens and offers some of the most stunning features seen throughout the house. The Great Hall can accommodate wedding ceremonies for up to 100, dining also for 100 and up to 140 for evening receptions and dancing. Featuring high ceilings, wood panelled walls and chandelier lighting, the Great Hall evokes the memories of candlelit banquets, family celebrations and entertaining to impress.

Alternatively, the Great Hall can be used for a range of conferences, trade shows and other private events.







## Tudor Kitchen

The Tudor Kitchen is located directly off the Great Hall and is perfect for ceremonies for up to 100 and then as a separate area for your evening bar or buffet. Alternatively, the space can be used for breakout sessions from the main hall or as an area for lunch and refreshments during a larger conference.

Featuring a range of period features such as the stone lined walls, leaded windows and a Tudor-style beamed ceiling, this space offers the chance for more atmospheric ceremonies, brought to life with battery candles and creative lighting design.





## Great Chamber & Long Gallery

The Great Chamber offers a smaller, more exclusive atmosphere for ceremonies, accommodating up to 50 guests and provides views across the West Lawns and Queen's Beasts; the famous topiary sculptures. Directly off the Great Chamber is the Long Gallery, an ideal space for daytime meetings.

Both spaces can be used for receptions, private dining or smaller meetings.







## Parlour & Chapel

With views onto the Topiary Lawn, the Parlour has wood panelled walls and chandelier lighting. Suitable for intimate private dining events, meetings and ceremonies, it is linked to the Chapel which works well as an additional space. The Chapel gives you direct access to the Private North Courtyard for guests to enjoy some outdoor space.







## North Courtyard

This private, outdoor space provides some of the best views of the oldest part of the house and its architecture. Located directly off the Great Hall and Tudor Kitchen, the North Courtyard is perfect for summer events and drinks receptions.

Relax and catch up with guests as canapés and drinks are served under the imposing Great Hall windows and the beautiful stonework.





## Gardens

The award winning gardens of Hall Place provide the perfect opportunity for a range of photographs to capture your special day. Whether it's the happy couple or the whole wedding party, guests are welcome to enjoy the formal landscaped gardens or the more natural areas such as the river, expansive lawns and hidden clearings.





## Riverside Café

The sound of the rushing weir and views over the extensive parkland makes the Riverside Café a stunning alternative venue for smaller events. Available for set-up from 6pm each day, this beautiful light and airy space is the perfect location for a small dinner, exclusive drinks reception or a standing buffet with the option of summer BBQs.





## Ceremonies

Holding your ceremony at Hall Place and Gardens will provide an unforgettable experience, full of history and romance.

We have five beautiful licenced spaces of varying sizes and style which will ensure you have the perfect location for when you take your vows. The private courtyard and gardens are an idyllic backdrop for your photos. You have exclusive use during your celebrations, so you can be confident in being the only newlyweds on site.







## Wedding Package

Our team understands how stressful planning your wedding day can be and are able to offer a fantastic wedding package focusing on the most important elements whilst still allowing for personal touches to be added to make your day unique.

The package also covers your post-ceremony reception drink, perfectly paired wines for your meal and a glass of fizz for the toast.

Once the evening gets going and the dance floor fills up, Relish will provide a tasty evening buffet, perfect for refuelling and dancing the night away.

[www.relish.co.uk](http://www.relish.co.uk)  
[food@relish.co.uk](mailto:food@relish.co.uk)

### Food and Beverage

Our exclusive catering company, Relish, can provide a range of options for your wedding menu choices with many delicious dishes and handpicked seasonal ingredients. Relish are experts in professional service and have an excellent understanding of the venue.

The full menus can be found on our website.

*"We thoroughly enjoyed our day and were so very pleased with every aspect – it was fantastic. Thank you so much for all of your support over the last ten months, it has been super and for all of the staff's assistance on the day – it made for a wonderful experience."*





## Private & Corporate Events

All of our amazing spaces can be used for meetings and conferences. Small meetings and breakout sessions can also be held in the Limerick Room.

Private events, birthdays, anniversaries and other social gatherings all work perfectly in this beautiful venue.

The dedicated Hall Place team can suggest magical ways to dress the space and provide an unforgettable experience for your guests.





# Useful Information

## Great Hall

| Reception | Seated Dinner | Theatre/Ceremony | Boardroom |
|-----------|---------------|------------------|-----------|
| 140*      | 100           | 100              | 34        |

## Tudor Kitchen

| Reception | Seated Dinner | Theatre /Ceremony |
|-----------|---------------|-------------------|
| 100*      | 32            | 100               |

## Parlour & Chapel

| Reception | Seated Dinner | Theatre/Ceremony | Boardroom |
|-----------|---------------|------------------|-----------|
| 40        | 30            | 40               | 22        |

## Great Chamber & Long Gallery

| Reception | Seated Dinner | Theatre/Ceremony | Boardroom |
|-----------|---------------|------------------|-----------|
| 50        | 40            | 50               | 22        |

## Limerick Room

| Reception | Seated Dinner | Boardroom |
|-----------|---------------|-----------|
| N/A       | 12            | 12        |

## Riverside Café

| Reception | Seated Dinner |
|-----------|---------------|
| 100       | 50            |

\* When hired in conjunction with the Tudor Kitchen/Great Hall

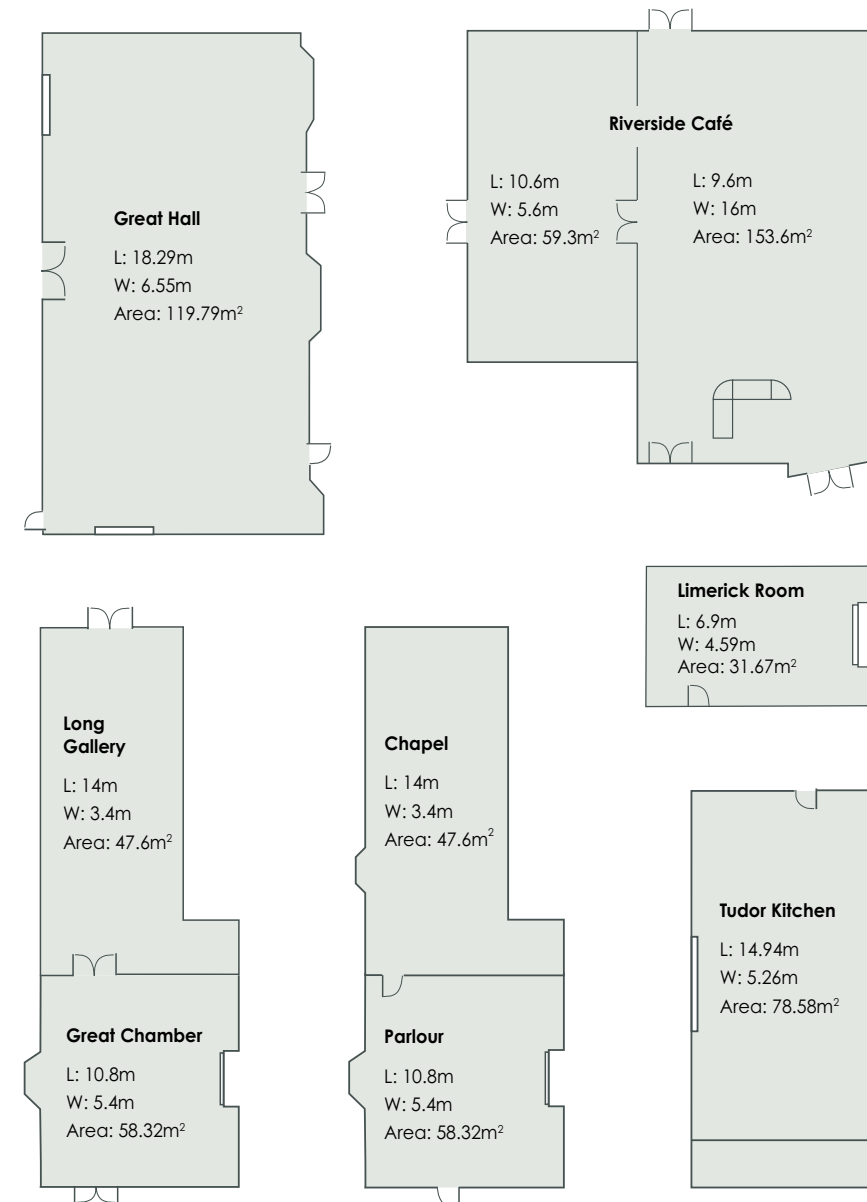

Not to scale





## Contact us

Hall Place is the perfect location for weddings, conferences, celebrations and parties. Located just off the A2 close to the M25 with ample parking and direct rail links to London, Hall Place offers an inspirational venue which will impress guests and clients.

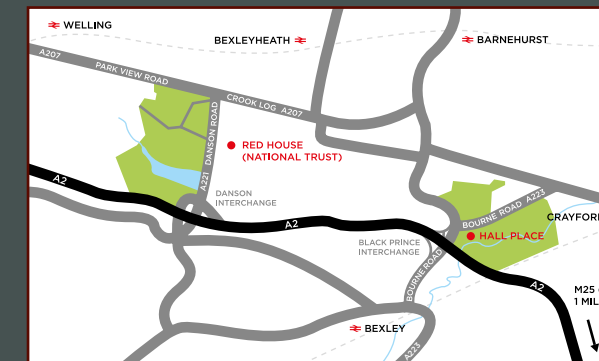

Hall Place & Gardens  
Bourne Road,  
Bexley, Kent DA5 1PQ  
[www.hallplace.org.uk](http://www.hallplace.org.uk)  
020 3045 4088  
[hallplacefunctions@bexley.gov.uk](mailto:hallplacefunctions@bexley.gov.uk)

### PHOTO CREDITS

John Nassari, My Beautiful Bride, Filmmakers of London, Corpix Photography Ltd,  
Luke Granger Photography, Matt Rock Photography





---

Hall Place & Gardens, Bourne Road, Bexley, Kent DA5 1PQ

[www.hallplace.org.uk](http://www.hallplace.org.uk)

020 3045 4088

[hallplacefunctions@bexley.gov.uk](mailto:hallplacefunctions@bexley.gov.uk)